

EPIC® H-A 32 SDRL-BO

Rugged housings for 2 inserts

The compact robust housing has 2 cable entries and pivots for a double lever, which makes it the ideal option for use in control systems.

Info

Compact, robust metal housings for double size H-A 32

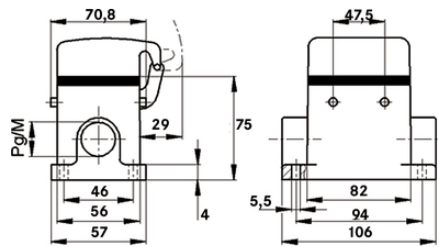

Waterproof



Robust



Mechanical resistance



Mechanical and plant engineering

Benefits

For two inserts of the small H-A, H-D and STA series. Space-saving

Application range

Machine and equipment manufacturing
Control engineering

Product features

Surface-mount base
Bolts for double lever
2 cable entries
Metal cover

Technical Data

Last Update (22.12.2022)

©2022 Lapp Group - Technical changes reserved

Product Management www.lappkabel.de

You can find the current technical data in the corresponding data sheet.

PN 0456 / 02_03.16

EPIC® H-A 32 SDRL-BO

Classification ETIM 5:	ETIM 5.0 Class-ID: EC000437 ETIM 5.0 Class-Description: Housing for industrial connectors
Classification ETIM 6:	ETIM 6.0 Class-ID: EC000437 ETIM 6.0 Class-Description: Housing for industrial connectors
Material:	Housing: aluminium alloy, grey Lever: zinc-plated steel Sealing: NBR
Protection rating:	IP 65 (latched) IP 40 (cover closed)
VDE-tested:	UL-tested: UL File Number: E75770
Temperature range:	-40°C to +100°C, short-term up to +125°C

Note

Photographs and graphics are not to scale and do not represent detailed images of the respective products.
Prices are net prices without VAT and surcharges. Sale to business customers only.

EPIC® H-A 32 SDRL-BO

Article number	Article description	M	PG	Neck
H-A housing: surface-mount base (cover, 2 cable entries, bolts for double lever)				
70516200	H-A 32 SDRL-BO 21	-	21	yes
79516200	H-A 32 SDRL-BO M25	25	-	yes
79516400	H-A 32 SDRL-BO M32	32	-	yes

Last Update (22.12.2022)

©2022 Lapp Group - Technical changes reserved

Product Management www.lappkabel.de

You can find the current technical data in the corresponding data sheet.

PN 0456 / 02_03_16