

## EPIC® SIGNAL M23 B1

Circular connectors for Servo Cables and encoders

EPIC® M23 panel base for back wall assembly

### Info

Housing for mounting at inner side to save space outside of device

Made in Germany

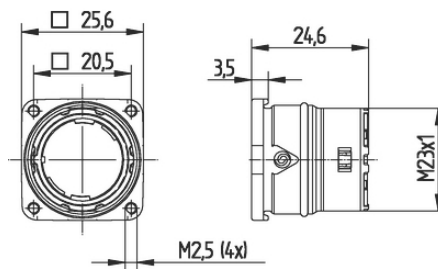

Mechanical and plant engineering



Wind Energy



Good chemical resistance



Robust



Interference signals

### Benefits

Defined stop position when mounting at device prevents uncontrolled pressing of sealing

Harnessed insulation body can easily inserted from back side in already mounted housing

### Application range

Plant engineering

Servo drives and servo assemblies

Measurement and control technology

### Technical Data

Last Update (27.04.2024)

©2024 Lapp Group - Technical changes reserved

Product Management [www.lappkabel.de](http://www.lappkabel.de)

You can find the current technical data in the corresponding data sheet.

PN 0456 / 02\_03.16

## EPIC® SIGNAL M23 B1

Classification ETIM 5:	ETIM 5.0 Class-ID: EC000437 ETIM 5.0 Class-Description: Housing for industrial connectors
Classification ETIM 6:	ETIM 6.0 Class-ID: EC000437 ETIM 6.0 Class-Description: Housing for industrial connectors
Material:	Housing: nickel-plated zinc die-casting Sealing: FPM
Protection rating:	IP68 (10h/1m)
VDE-tested:	Certified production control: VDE-REG. no. C24 (according to EN 61984, SELV according to DIN VDE 0100-410 has to be guaranteed) UL File Number: E249137
Temperature range:	-25°C up to +125°C

### Note

Photographs and graphics are not to scale and do not represent detailed images of the respective products.  
Prices are net prices without VAT and surcharges. Sale to business customers only.

**EPIC® SIGNAL M23 B1**

Article number	Article	Coding	Fastening type	Pieces / PU
Type M23 B1 panel-mount box, rear wall mounting				
44420024	M23 B1	black (N)	M2.5 (4x)	5
44420023	M23 B1	black (N)	M2.5 (4x)	20
44420026	M23 B1	red (+20°)	M2.5 (4x)	5
44420025	M23 B1	red (+20°)	M2.5 (4x)	20
44420022	M23 B1	blue (-20°)	M2.5 (4x)	5
44420021	M23 B1	blue (-20°)	M2.5 (4x)	20

Last Update (27.04.2024)

©2024 Lapp Group - Technical changes reserved

Product Management [www.lappkabel.de](http://www.lappkabel.de)

You can find the current technical data in the corresponding data sheet.

PN 0456 / 02\_03.16