

## EPIC® POWER LS1 F7

Circular connectors for servomotors and power supply

EPIC® LS1 Power cable coupler with flange for cable extensions for wall mounting

### Info

For fast and safe wall mounting of a cable extension

Made in Germany

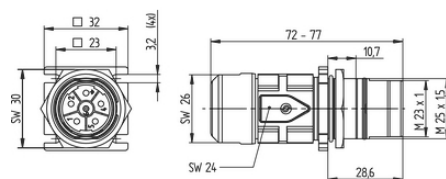

Mechanical and plant engineering



Wind Energy



Good chemical resistance



Corrosion-resistant



Maximum vibration protection



Mechanical resistance



Assembly time



Optimum strain relief



Space requirement

Last Update (30.12.2023)

©2023 Lapp Group - Technical changes reserved

Product Management [www.lappkabel.de](http://www.lappkabel.de)

You can find the current technical data in the corresponding data sheet.

PN 0456 / 02\_03.16

## EPIC® POWER LS1 F7



Robust



Integrated SKINTOP<sup>®</sup> cable gland



Interference signals



Waterproof



Variety of approval certifications

### Benefits

High power at smallest installation space, Optimal solution for electric motors

EMC-optimised design

Safety use in field environment by high protection class

### Application range

Plant engineering

Servo drives and servo assemblies

### Technical Data

Classification ETIM 5:

ETIM 5.0 Class-ID: EC002635

ETIM 5.0 Class-Description: Circular connector (industrial connector)

Classification ETIM 6:

ETIM 6.0 Class-ID: EC002635

ETIM 6.0 Class-Description: Circular connector (industrial connector)

Rated voltage (V):

630 V (2 mm contacts)

250 V (1 mm contacts)

Rated impulse voltage:

6 kV (2 mm contacts)

4 kV (1 mm contacts)

Rated current (A):

26A/3+PE+4, 25A/5+PE (2mm contacts)

7 A (1 mm contacts)

Pollution degree:

3

Contact resistance:

< 4 mOhm

Contacts:

Gold-plated brass

Number of contacts:

3+PE+4(2mm/1mm)

5+PE(2mm)

Termination methods:

Crimp termination: 0.5 - 4.0 mm<sup>2</sup> (2 mm contacts)

Crimp termination: 0.14 - 1.0 mm<sup>2</sup> (1 mm contacts)

Material:

Housing: nickel-plated zinc die-casting, nickel-plated brass

Insert: PA,

Seal: FPM

Protection rating:

IP68 (10h/1m)

Cycle of mechanical operation:

500

Last Update (30.12.2023)

©2023 Lapp Group - Technical changes reserved

Product Management [www.lappkabel.de](http://www.lappkabel.de)

You can find the current technical data in the corresponding data sheet.

PN 0456 / 02\_03.16

## EPIC® POWER LS1 F7

VDE-tested:

UL File Number: E249137

Temperature range:

-25°C up to +125°C

### Note

Photographs and graphics are not to scale and do not represent detailed images of the respective products.  
Prices are net prices without VAT and surcharges. Sale to business customers only.

# EPIC® POWER LS1 F7

Article number	Article description	Contacts included	Clamping range min	Clamping range max	Clamping range in mm	Fastening type	Pin configuration	Pieces / PU
Type LS1 F7, cable coupler wih mounting flange, 6-pin, for male contacts								
73000020	LS1 F7	6	8.5	11	8.5 - 11	Ø 3.2 mm (4x), M25 x 1.5 (with nut)	5+PE	5
73000021	LS1 F7	6	10.5	15.5	10.5 - 15.5	Ø 3.2 mm (4x), M25 x 1.5 (with nut)	5+PE	5
73000023	LS1 F7	-	10.5	15.5	10.5 - 15.5	Ø 3.2 mm (4x), M25 x 1.5 (with nut)	5+PE	20
76143000	LS1 F7	6	7.5	15.5	7.5 - 15.5	Ø 3.2 mm (4x), M25 x 1.5 (with nut)	5+PE	5
Type LS1 F7, 8-pin, for male contacts								
73000016	LS1 F7	8	8.5	11	8.5 - 11	Ø 3.2 mm (4x), M25 x 1.5 (with nut)	3+PE+4	5
73000017	LS1 F7	8	10.5	15.5	10.5 - 15.5	Ø 3.2 mm (4x), M25 x 1.5 (with nut)	3+PE+4	5
76144000	LS1 F7	8	7.5	15.5	7.5 - 15.5	Ø 3.2 mm (4x), M25 x 1.5 (with nut)	3+PE+4	5
76144510	LS1 F7	-	7.5	15.5	7.5 - 15.5	Ø 3.2 mm (4x), M25 x 1.5 (with nut)	3+PE+4	20