

## EPIC® H-A 3 MTS

Innovative metal and plastic housing design

The compact metal housing is ideal for use in control systems and for supplying power in restricted spaces.

### Info

Small, rugged metal housing

Protection rating UL50E tested

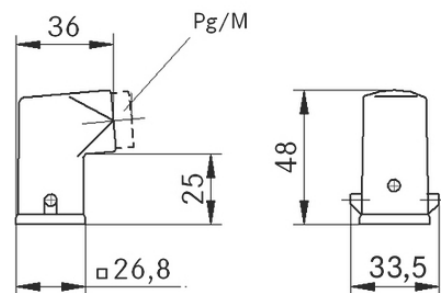

Mechanical and plant engineering



Mechanical resistance



Robust



Waterproof

### Benefits

The EPIC® H-A 3 series comprises the smallest housings in the heavy-duty industrial connector range and ensures secure connections in the smallest of spaces.

The hood housing is mateable with many commercially available housings (panel-mount base, surface-mount base or coupler hood housings).

Locking is via single lever on the counterpart.

With threaded hole for use with a corresponding cable gland.

The arrow as a new design element on the surface of the housing is easy to feel and simplifies plugging in spatially confined and possibly poorly visible application areas.

### Application range

To protect the connector insert from environmental influences.

For use with many EPIC® rectangular connector inserts.

For power supply connection of devices and machines in various applications.

Last Update (24.04.2024)

©2024 Lapp Group - Technical changes reserved

Product Management [www.lappkabel.de](http://www.lappkabel.de)

You can find the current technical data in the corresponding data sheet.

PN 0456 / 02\_03.16

## EPIC® H-A 3 MTS

Withstands high environmental and mechanical stresses.

### Product features

Hood  
Bolts for single lever  
Side cable entry  
Versions with / without cable gland  
Metal housing

### Technical Data

Classification ETIM 5:	ETIM 5.0 Class-ID: EC000437 ETIM 5.0 Class-Description: Housing for industrial connectors
Classification ETIM 6:	ETIM 6.0 Class-ID: EC000437 ETIM 6.0 Class-Description: Housing for industrial connectors
Material:	Housing: powder-coated zinc die-casting, grey Lever: zinc-plated steel
Protection rating:	IP 65 (latched) NEMA 250, UL50E: 12, 4 (latched)
VDE-tested:	Certified production control: VDE-REG. no.: B437 UL-tested: UL File Number: E75770
Temperature range:	-40°C to +100°C, short-term up to +125°C

### Note

Photographs and graphics are not to scale and do not represent detailed images of the respective products.  
Prices are net prices without VAT and surcharges. Sale to business customers only.

EPIC® H-A 3 MTS

Article number	Article description	M	PG	Material	Colour	Cable gland	Cable clamping range	Pieces / PU
H-A housing: hood (side cable entry)								
10512300	H-A 3 MTS 11	-	11	Zinc die-casting	grey	-	-	10
10427500	H-A 3 MTS 11 kpl	-	11	Zinc die-casting	grey	yes	6.5 - 12	10
19512300	H-A 3 MTS M20	20	-	Zinc die-casting	grey	-	-	10
19427500	H-A 3 MTS M20 kpl.	20	-	Zinc die-casting	grey	yes	3 - 13.5	10